



Collet chuck ER HSK-A63

balanced G6,3 at 20.000 rpm

Endmill-holder Weld. HSK-A63

balanced G6,3 at 20.000 rpm

Face mill holder HSK-A63

balanced G6,3 at 15.000 rpm

Article-code

ER x A

G610A63	16	x	100
G610A63	16	x	160
G610A63	25	x	100
G610A63	25	x	160
G610A63	32	x	100
G610A63	32	x	160
G610A63	40	x	120
G610A63	40	x	160

Run-out: 5 µm max.

Article-code

d1 x A

G620A63	6	x	65
G620A63	6	x	100
G620A63	6	x	160
G620A63	8	x	65
G620A63	8	x	100
G620A63	8	x	160
G620A63	10	x	65
G620A63	10	x	100
G620A63	10	x	160
G620A63	12	x	80
G620A63	12	x	100
G620A63	12	x	160
G620A63	16	x	80
G620A63	16	x	100
G620A63	16	x	160
G620A63	20	x	80
G620A63	20	x	100
G620A63	20	x	160
G620A63	25	x	110
G620A63	32	x	110

Article-code

d1 x A

G643A63	16	x	45 K
G643A63	22	x	50 K
G643A63	27	x	60 K
G643A63	32	x	60 K
G643A63	40	x	60 K

with internal coolant supply

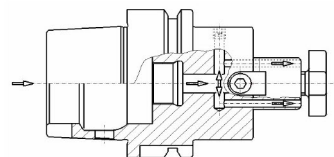

Shrink-fit holder HSK-A63

balanced G2,5 at 20.000 rpm

Morse taper adaptor MT / flat tang

balanced G6,3 at 20.000 rpm

Article-code

d1 x A

G628A63	6	x	80
G628A63	8	x	80
G628A63	10	x	85
G628A63	12	x	90
G628A63	16	x	90
G628A63	20	x	100
G628A63	25	x	115

Article-code

MK x A

G660A63	1	x	100
G660A63	2	x	120
G660A63	3	x	140
G660A63	4	x	160

Run-out: 3 µm max.

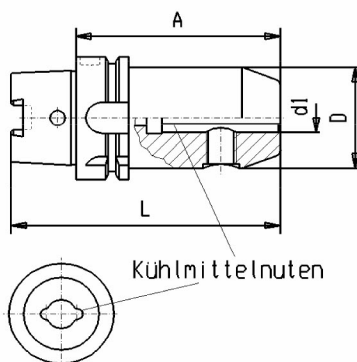

Endmill-hold. Weldon HSK-A63 with COOLANT-GROOVES

Article-code

d1 x A

G623A63	8	x	65
G623A63	10	x	65
G623A63	12	x	80
G623A63	16	x	80
G623A63	20	x	80
G623A63	25	x	110



Morse taper adaptor MT / thread

balanced G6,3 at 20.000 rpm

Article-code

MK x A

G661A63	2	x	120
G661A63	3	x	140